



TRANS GLOBE
L I G H T I N G

Job Name:	Job Type:
Fixture Location:	QTY:
Additional Notes:	

Elm LED Disk Light w/ Motion Sensor

LED-40030-MS

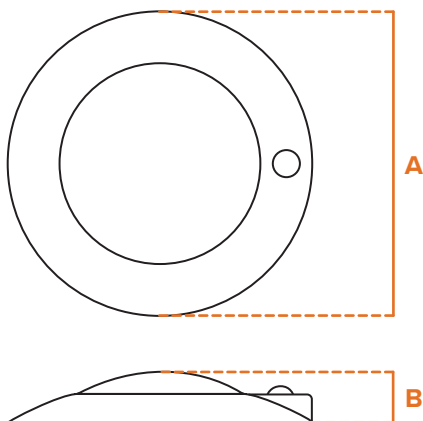

Available Sizes	7"
Wattage	14W
Lens Type	Frosted White Plastic
Bulb Type	LED Integrated
Color Temp	27K, 3K, 35K, 4K, 5K CCT Selectable
Lumens (Int/Del)	1250Lm / 1000Lm
CRI	90
Available Finishes	WH
Voltage	120V
Dimmable	N/A (Motion Sensor)
Materials	Steel
Operating Temp	-20° to 40°C / -4° to 104°F
Sloped Ceiling Adpt.	Yes
Illumination Direction	Down
Motion Sensor Timing	1 min, 3 min, 5 min Adjustable
Warranty	Fixture: 1 year Limited Warranty Finish: 6 Months in normal climatic conditons LED Module: Rated for 5 years / 50,000 hrs

Dimensions

	A	B
LED-40030-MS	7.5" Dia	1.4" H

Certifications



Shipping Box	Width	Height	Depth	Ship Wt	Method	Oversize	Case QTY
Ship QTY: 1ea.					Ground	No	
UPC: by finish				Finish:			

Additional Images



Front View



Side View

Standard Accessories



Wire Nuts



Screws

Photometrics

LED-40030-MS

