

Mechanical Data:

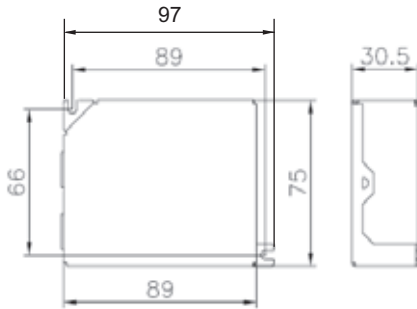

CASE MATERIAL
 CASE LENGTH
 CASE WIDTH
 HEIGHT
 OVERALL LENGTH
 MOUNTING LENGTH
 WEIGHT

ALUMINUM
89mm, 3.5"
75mm, 2.95"
30.5mm, 1.20"
97mm, 3.82"
89mm, 3.5"
0.62 lbs

Hot Spot:

Tcase max: 85°C



Electrical Data:

LAMP
 INPUT VOLTS
 LINE CURRENT (AMPS)
 INPUT POWER (WATTS)
 MIN POWER FACTOR
 MIN STARTING TEMPERATURE
 THD
 ANSI CODE
 CCF
 EMI/RFI
 FREQUENCY
 TYPE

1 LAMP, 20-22W MH
120
0.21
25W
>0.98
-30°C/-20°F
<15%
M156, C156, C175, M175
<1.5
FCC PART18 CLASS A, NON-CONSUMER
140-220 Hz
1 OUTDOOR

Wiring Diagram:

WIRE	BLACK	WHITE	RED	BLUE	GREEN
LENGTH	9"	9"	9"	9"	9"

Bottom View, Side Leads

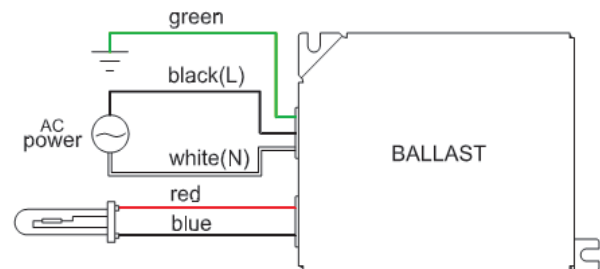

Ballast Case Must Be Grounded.

Installation & Application:

1. Maximum allowable case temperature is 85°C. See Hot Spot section for measurement location.
2. Ignition pulse is 4kV max.
3. Ballast output will shutdown after 25 minutes if lamp fails to ignite.
4. Power must be cycled off then on, after replacing lamp.
5. Do not install insulation above or within 3 inches of ballast sides
6. Can be remotely installed up to 12 feet from lamp.

Performance:

1. Short Circuit Operation Protection
2. Open Circuit Operation Protection
3. Ignitor Failure Protection
4. End of Lamp Life Protection