

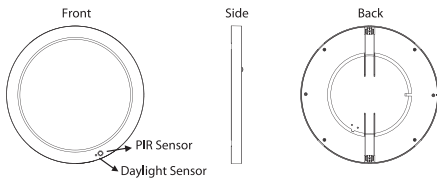

LED ROUND MINI PANEL MOTION SENSOR FIXTURE  
ITEM# 81325-SU, 81327-SU, 81329-SU

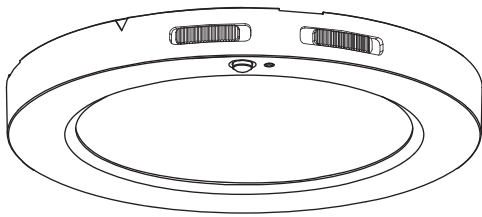

**Please read and understand this entire manual before attempting to assemble, operate or install the product.**

**WARNING:** BE SURE THE POWER IS OFF! Risk of electric shock, always use the switch to power off. Do not perform any operations while this unit is powered on. The electrical system you want to connect the device to must be grounded. Read the instructions before using or powering this device. The safety instructions must be taken into account and respected in order to avoid user error, which can cause damages. The operating instructions must remain with the unit in case of transfer. Any damage to the device linked to an inappropriate use is excluded from support by the warranty. Before connecting, make sure that the current and voltage are compatible with this device. We highly recommend that all installations are made by a QUALIFIED ELECTRICIAN. We are NOT responsible by any means for the use or misuse of the following information. We are NOT responsible in whole or in part for any harm or damage that may or may not be caused. We reserve the right to revise the components of any product, due to part availability or change in ETL, CUL or UL standards without assuming any obligation or liability to modify any products previously manufactured and without notice. These instructions do not cover all details of variations in equipment, nor do they provide every possible contingency to be met. Turn off / unplug power when installing or servicing this device.



10-100% DIMMABLE

\*The luminaire may not be compatible with all dimmers.  
Go to [www.Sunlite.com/Dimmers](http://www.Sunlite.com/Dimmers) to find dimmer compatibility information.



**Included Parts**

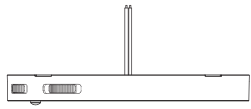

Flush Mount Fixture



Installation Bracket & Screws



Safety Rope



Wire Nuts

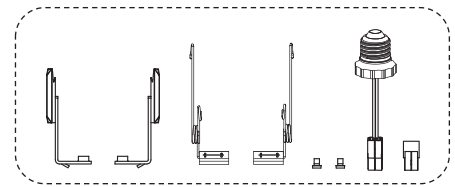

Retrofit Accessories

**Required Tools (not included)**



Gloves



Safety Goggles

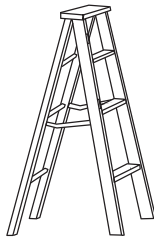

Ladder



Wire Cutter



Wire Stripper

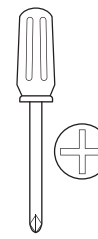

Phillips Screwdriver

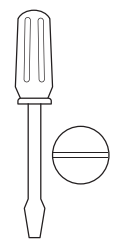

Flathead Screwdriver

**Note: For 81325-SU, sensor and dimming can't work together. One functionality should be turned off / not used.**

**CCT Tunable Switch**

From left to right: 27K / 30K / 35K / 40K / 50K



**Sensor Function Tunable Switch**

**Left (OFF):** Turn off sensor function  
**Middle (Bi-level):** Normal <25% rated wattage output. 100% wattage output when the PIR sensor detected.  
**Right (ON/OFF):** Normal 0% output. 100% output when the PIR sensor detected.  
 (The Daylight Sensor operates in conjunction with the PIR sensor. The light fixture turns on when the ambient light falls below 30 lux, and turns off when the ambient light exceeds 90 lux, with a tolerance of +/- 5 lux.

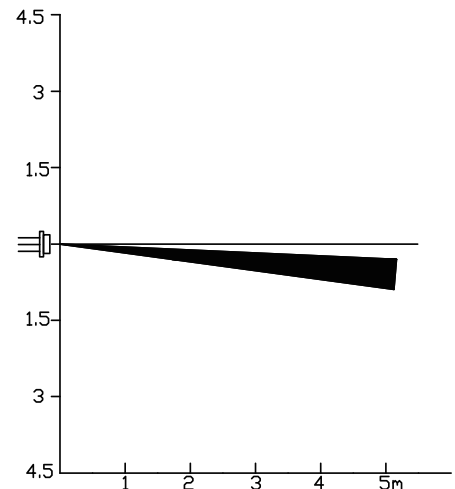
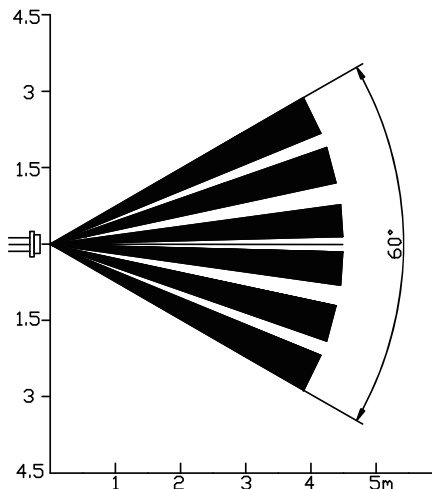

**Effective PIR Sensor Range**

### Junction Box Mounting

**Step 1:** Attach installation bracket with screws to junction box and connect ground wire (fig. A).

**Step 2:** Fix safety rope from installation bracket to fixture (fig. B).

**Step 3:** Connect black wire to live wire, white wire to neutral wire, and secure using quick connector (fig. C).

**Step 4:** Position fixture marking with mounted bracket and push up until it clicks into place (fig. D).

*Note: To remove, pull down hard or use a flathead screwdriver to pry off.*

**Step 5:** Select desired color temperature and motion sensor option located on the side of the fixture.

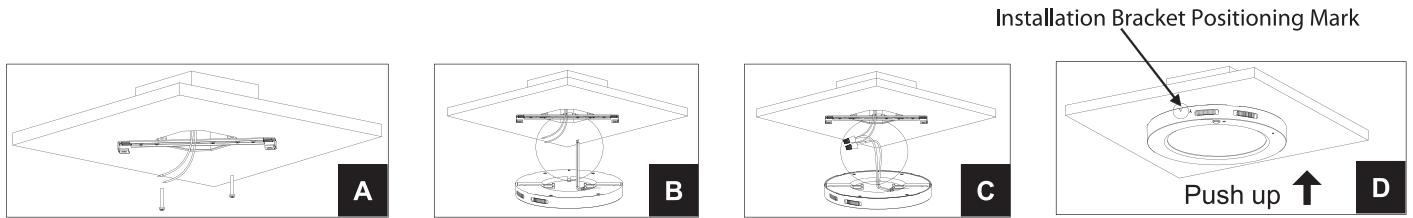

### Recessed Housing Mounting

**Step 1:** Attach housing clips to fixture bracket with screws, at desired location for size required (fig. E).

**Step 2:** Position fixture markings with fixture bracket and push down until it clicks into place. Connect white wire and black wire to the connector male terminal (fig. F).

**Step 3:** Twist screw base adapter to fixture socket as below (fig. G).

**Step 4:** Connect the quick connector. Push clips into recessed can to install fixture (fig. H & I).

